

# Volvo Tooth System Handbook.

## New generation



Edition: 1.1

Editor:

Håkan Karlsson, Product Manager Wear Parts

Phone: +46735585764

Mail: [hakan.g.karlsson@volvo.com](mailto:hakan.g.karlsson@volvo.com)

**Table of contents**

**Page:**

4 - Introduction, how it started.  
5 - Overview of the system  
6 - Features & Benefits of the system  
7 - Excavator parts system features & benefits data  
9 - Wheel Loader parts system features & benefits data  
11 - Excavators – Dimensions and Weight Teeth & Adapter  
14 - Wheel Loaders – Dimensions and Weight Teeth & Adapter  
17 - L60, L70, L90  
18 - L110, L120  
19 - L150  
20 - L180, L220  
21 - L250, L260, L330, L350  
22 - EC140, ECR145  
23 - EC160, EC180  
24 - EC200, EC210  
25 - EC220, EC230 Electric  
26 - EC235, ECR235  
27 - EC250, EC300  
28 - EC350, ECR355  
29 - EC380, EC480  
30 - EC530, EC550  
31 - EC700, EC750, EC950  
32 - EWR130, EWR150  
33 - EW160, EWR170  
34 - EW180, EW220  
35 - Attachment Selector Application

**Once upon a time...**

After some years of developing - The first Volvo Tooth System saw the daylight.  
Volvo Construction Equipment released their own patented tooth system – It was 2004!  
2019 it was time for a new era and a new patented system was presented to the markets!

**For the new system there are 2 applicable patents.**

- For the fitting area (interface between adapter and tooth), called VTS-II: Global PCT was applied, and it has been extended in the following countries: Australia, Brazil, Canada, Chile, China, South Korea, Japan, India, Indonesia, Israel, Malaysia, Mexico, New Zealand, Peru, Russia, Sudan, South Africa, Ukraine, USA, and European Patent (pending national phase).  
Filing date 29 April 2014.  
Number: PCT/EP2014/058702 (Publication No. WO2015/165505)
- For the locking system patent. Global PCT was applied, and it has been extended in the following countries: Australia, Brazil, Canada, Chile, China, South Korea, Japan, India, Indonesia, Israel, Malaysia, Mexico, New Zealand, Peru, Russia, Sudan, South Africa, Ukraine, USA, and European Patent (pending national phase).  
Filing date 05/07/2011.  
Number: PCT/EP2011/070488 (Publication No. WO2013/004858)

**Modern design based on the best available experience.**

- The new generation Volvo Tooth System is developed by Volvo, for Volvo.
- The adapter and tooth are specifically matched to the size and model of your Volvo machine, helping to deliver maximum performance, breakout force and uptime.
- From the correct tooth size and specification to the optimal balance of wear protection and weight, every detail has been precision engineered to unlock the full potential of your Volvo.
- A genuinely hammerless solution with the new Volvo locking system you can install or change teeth in minutes, helping to minimize downtime.
- The retainer and the tooth are assembled and supplied together, and no spring retainer replacement is required during the tooth life.
- The smart system works with a reusable locking pin, which can be mounted from both sides.
- A genuinely hammerless solution reducing the risk of injury. Only a ½” and/or 3/8” square male tool needed.

**Aimed at Volvo’s larger Excavators and Wheel Loaders.**

- Volvo Wheel Loaders between L60 to L350.
- Volvo Excavators from 14-ton capacity up to its largest 95-ton machine.



**Tooth**

- Low profile for good penetration.
- Stronger self-sharpening design.
- Redesigned cross section areas for a more even wear.
- Stronger ribs, resulting in excellent penetration and cycle times.

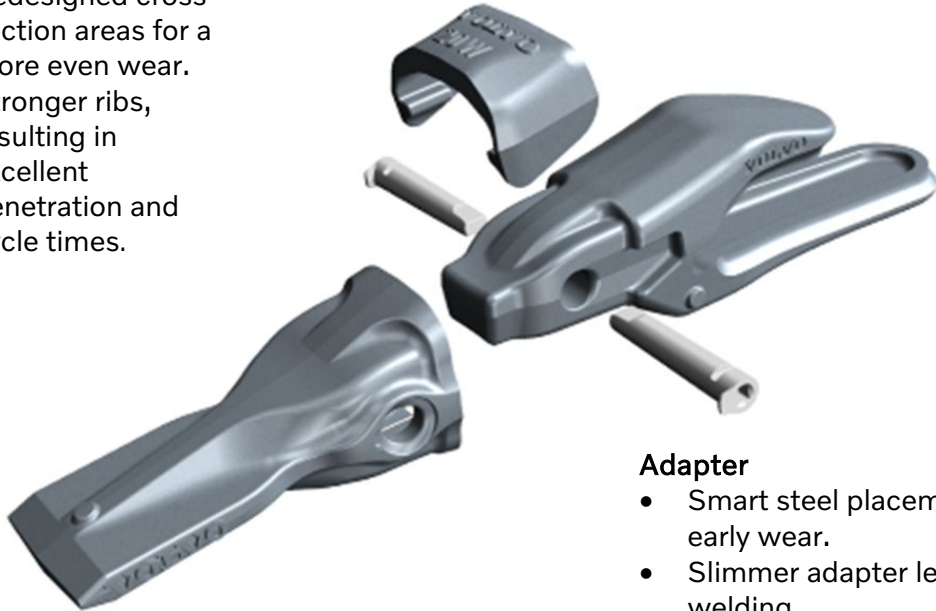

**Wear Cap**

- Optional wear placement cap, fitted on the same adapter.
- Can be used with or without wear cap (size 41 and up).

**Adapter**

- Smart steel placement prevents early wear.
- Slimmer adapter leg protects the welding.
- Improved behavior against overloads.
- Reusable pin, lockable from both sides (size 21 up to 126).

**Locking System**

- Reusable pin, lockable from both sides (size 21 up to 126).
- Steel retainer pre-mounted into the tooth box
- The spring retainer and the tooth are assembled and supplied together
- No spring replacement is necessary during the tooth life
- The locking pin is made by steel
- No need of a separate "Hot-slag" pin or retainer.
- Only one locking system for both normal use and Hot-slag use.



Excavator parts system features & benefits data



**General Purpose Tooth:**

For general purpose applications with a moderate level of abrasion. Good penetration. Long service life

**Designation: GPE**



**Abrasive material and rock Tooth:**

Provides good penetration and longer service life in rock and abrasive material handling. For Rock material handling where extra wear life is needed.

**Designation: ARXE**



**Top leg adapter:**

Adapter with long top leg for welding to both sides of the cutting edge.

**Designation: TL**



**Pick Point Tooth:**

The perfect choice for extremely compact material, such as hard clay and frozen ground, providing maximum penetration capability.

Can be used in combination with Twin Pick tooth. Long service life.

**Designation: PPC / PPE**



**Twin Pick Point Tooth:**

The perfect choice for extremely compact material, such as hard clay and frozen ground, providing maximum penetration capability. Can be used in combination with Pick Point tooth. Long service life.

**Designation: TPC / TPE**



**Spade Nose Tooth:**

Works best for light-duty, low impact applications, such as levelling, cleaning, grading, and backfilling.

**Designation: SNC / SNE**



**Wear Cap:**

Protecting adapter.

**Designation: W**



**Locking Pin:**

**Designation: P**



**Retainer:**

Retainer as spare part.

Include in the tooth.

**Designation: R**



Wheel Loader parts system features & benefits data



**General Purpose Tooth:**

An all-rounder suitable for material with a moderate level of abrasion, such as sand and gravel. Small undercut makes it suitable for cleaning work.

**Designation: GPL**



**Abrasive material Tooth:**

Designed to handle abrasive material, where extra penetration is required, such as crushed or blasted rock.

**Designation: AML**



**Abrasive material and Rock Tooth:**

For heavy duty applications with a high level of abrasion, such as blasted rock or hot slag.

**Designation: AMRL**



**Flush adapter:**

Flush-mounting weld-on adapter.

For use where a smooth profile to the bucket is required (e.g. planning, levelling).

**Designation: FC**



**Top leg adapter:**

Adapter with long top leg for welding to both sides of the cutting edge.

**Designation: TL**



**Bolt-on adapter:**

Two leg adapter for bolting to the cutting edge.

**Designation: BN**



**Locking Pin:**

**Designation: P**



**Retainer:**

Retainer as spare part.

Include in the tooth.

**Designation: R**

Excavators – Dimensions and Weight Teeth & Adapter

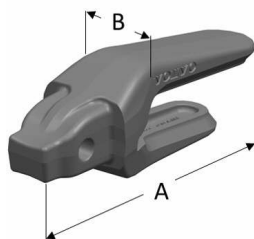

Adapters	Designation	Part No.	Edge thickness (mm)	Edge angle (mm)	A (mm)	B (mm)	Weight (kg)
	EA11TL25	VOE 17491921	25	30	267	91	4,5
	EA11TL30	VOE 14744545	30	30	256	91	4,4
	EA16TL30	VOE 14727403	30	30	299	104,2	6,5
	EA21TL40	VOE 14727405	40	30	344	112	9,8
	EA31TL40	VOE 14727406	40	30	377	123	12,1
Adapters	Designation	Part No.	Edge thickness (mm)	Edge angle (mm)	A (mm)	B (mm)	Weight (kg)
	EA41TLW40	VOE 14727409	40	30	436	115	18,9
	EA41TLW50	VOE 14732187	50	30	436	115	18,8
	EA56TLW50	VOE 14732190	50	30	479	132	25,4
	EA66TLW50	VOE 14732191	50	30	536	157	36,5
	EA66TLW60	VOE 14732192	60	30	536	157	36,5
	EA81TLW80	VOE 14732193	80	30	578	163	46,7
	EA126TLW90	VOE 14732194	90	30	670	193	76
	EA126TLW100	VOE 14732375	100	30	670	193	75

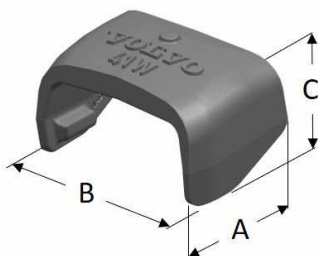

Wear cap	Designation	Part No	A (mm)	B (mm)	C (mm)	Weight (kg)
	41W	VOE 14736109	88	136	86	2
	56W	VOE 14736110	93	152	94	2,2
	66W	VOE 14736111	103	177	100	3,5
	81W	VOE 14736112	109	192	107	4
	126W	VOE 14736113	127	222	134	6,4

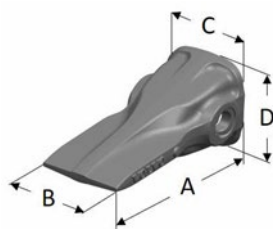

Teeth	Designation	Part No.	A (mm)	B (mm)	C (mm)	D (mm)	Weight (kg)
	11GPE	VOE 14744546	200	70	93	86	2,5
	16GPE	VOE 14732376	224	80	109	102	4,1
	21GPE	VOE 14732381	255	105	116	111	5,6
	31GPE	VOE 14732386	268	113	134	123	7,5
	41GPE	VOE 14732391	292	126	135	133	9,6
	56GPE	VOE 14732396	320	137	164	147	13
	66GPE	VOE 14732401	348	144	177	167	16,5
	81GPE	VOE 14732404	381	165	197	175	22,7

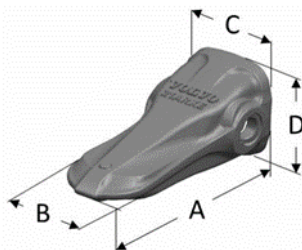

Teeth	Designation	Part No.	A (mm)	B (mm)	C (mm)	D (mm)	Weight (kg)
	11ARXE	VOE 14744547	212	73	93	86	3,1
	16ARXE	VOE 14732377	236	84	109	102	4,5
	21ARXE	VOE 14732382	269	95	116	111	6,8
	31ARXE	VOE 14732387	285	107	134	123	8,6
	41ARXE	VOE 14732392	312	120	141	133	12,2
	56ARXE	VOE 14732397	339	131	164	147	16,6
	66ARXE	VOE 14732402	382	147	178	167	22,5
	81ARXE	VOE 14731779	405	159	197	175	28,6
	126ARXE	VOE 14732425	464	179	216	205	42

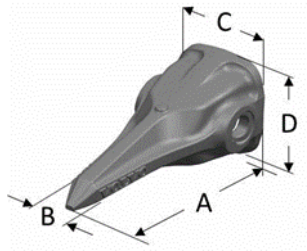

Teeth	Designation	Part No.	A (mm)	B (mm)	C (mm)	D (mm)	Weight (kg)
	16PPE	VOE 14732378	241	-	109	102	3,3
	21PPE	VOE 14732383	273	-	116	111	4,8
	41PPE	VOE 14732393	330	-	140	132	8,4
	56PPE	VOE 14732398	359	-	164	147	11,5
	66PPE	VOE 14732403	391	-	178	167	15
	81PPE	VOE 14732424	427	-	197	175	19,4
	126PPE	VOE14753794	486	-	217	205	35

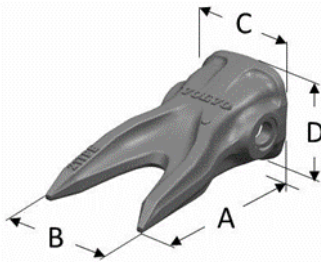

Teeth	Designation	Part No.	A (mm)	B (mm)	C (mm)	D (mm)	Weight (kg)
	16TPE	VOE 14732379	239	119	109	102	3,8
	21TPE	VOE 14732384	273	125	116	111	5,9
	41TPE	VOE 14732394	330	162	141	133	10,5
	56TPE	VOE 14732399	358	182	164	147	15

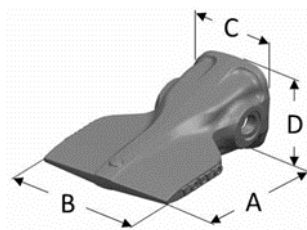

Teeth	Designation	Part No.	A (mm)	B (mm)	C (mm)	D (mm)	Weight (kg)
	16SNE	VOE 14732380	215	127	108	100	4,4
	21SNE	VOE 14732385	262	177	116	111	7,6
	31SNE	VOE 54099788	278	180	134	123	9,8
	41SNE	VOE 14732395	306	206	141	133	12,8
	56SNE	VOE 14732400	342	231	164	147	18,2
	66SNE	VOE 54099789	382	256	178	167	24,7

Wheel Loaders – Dimensions and Weight Teeth & Adapter



Adapter	Designation	Part No.	Edge thickness (mm)	Edge angle (degree)	A (mm)	B (mm)	Weight (kg)
	LA11FC25	VOE17491920	25	25	264	91	4.1
	LA16FC30-35	VOE17491922	30-35	25	301	104	6.1
	LA21FC40	VOE17491926	40	25	363	112	9.5
	LA31FC40	VOE17491928	40	25	387	123	13

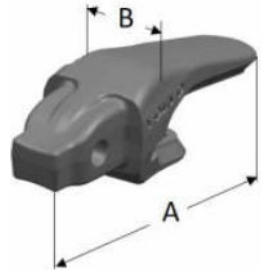

Adapter	Designation	Part No.	Edge thickness (mm)	Edge angle (degree)	A (mm)	B (mm)	Weight (kg)
	LA11TL25	VOE17491921	25	25	267	91	4.5
	LA16TL30	VOE17491923	30	25	298	104	6.3
	LA16TL35	VOE17491924	35	25	300	104	6.6
	LA21TL35	VOE17491925	35	25	323	112	8.1
	LA21TL40	VOE17491927	40	25	323	112	8.2
	LA31TL40	VOE17491929	40	25	350	123	11.2
	LA41TL40	VOE17491930	40	25	388	113	15.6
	LA41TL50	VOE17491933	50	25	395	113	16.2
	LA56TL65	VOE17491931	65	30	422	131	21.7
	LA66TL65	VOE17491932	65	30	504	140	31.2

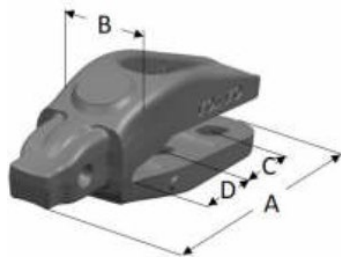

Adapter	Designation	Part No.	Edge thickness (mm)	Edge angle (degree)	A (mm)	B (mm)	C (mm)	D (mm)	Weight (kg)
	LA11BN25	VOE17491915	25	25	290	91	87	85	5.4
	LA16BN30	VOE17491916	30	25	307	103	87	85	6.9
	LA16BN35	VOE17491917	35	25	357	104	111	106	7.9
	LA21BN40	VOE17491918	40	25	390	112	100	117	14.4
	LA31BN40	VOE17491919	40	25	401	123	100	118	18.5

# V O L V O

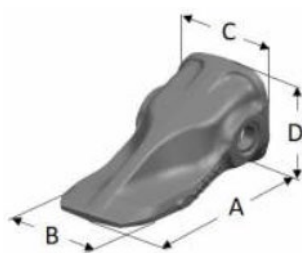

Teeth	Designation	Part No.	A (mm)	B (mm)	C (mm)	D (mm)	Weight (kg)
	11GPL	VOE17491940	186	76	93	86	2,5
	16GPL	VOE17491941	190	80	109	102	4,1
	21GPL	VOE17491944	194	104	116	111	5,5
	31GPL	VOE17491947	213	112	125	123	7,6
	41GPL	VOE17491950	226	130	141	133	10,8

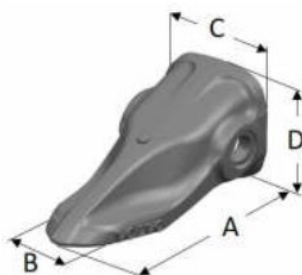

Teeth	Designation	Part No.	A (mm)	B (mm)	C (mm)	D (mm)	Weight (kg)
	16AML	VOE17491942	188	62	109	109	4,7
	21AML	VOE17491945	201	65	116	111	5,9
	31AML	VOE17491948	218	90	134	123	8,5

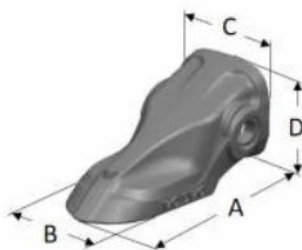

Teeth	Designation	Part No.	A (mm)	B (mm)	C (mm)	D (mm)	Weight (kg)
	16AMRL	VOE17491943	192	93	109	101	5,3
	21AMRL	VOE17491946	213	96	116	111	8,1
	31AMRL	VOE17491949	237	110	134	123	11,1
	41AMRL	VOE17491951	257	140	141	133	16,6
	56AMRL	VOE17491952	286	150	164	174	22,1
	66AMRL	VOE17491953	322	167	178	167	27,3

Locking devices – Excavators and Wheel Loaders – Dimensions and Weight

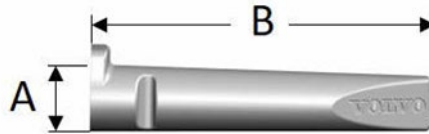

Pin	Designation	Part No	A (mm)	B (mm)	Weight (kg)
	11P	VOE 17473100	20	87	0,17
	16P	VOE 17473101	21	100	0,2
	21P	VOE 17473102	21	107	0,2
	31P	VOE 17473103	23,5	120	0,3
	41P	VOE 17473104	25	128	0,4
	56P	VOE 17473105	28,5	149	0,5
	66P	VOE 17473106	32	162	0,8
	81P	VOE 14740815	33,5	174	0,9
	126P	VOE14740817	39	192	1,4

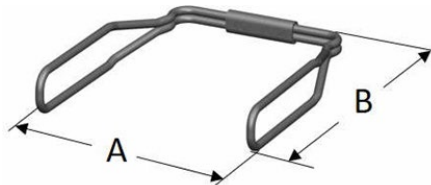

Retainer	Designation	Part No	A (mm)	B (mm)
	11R	VOE 17493100	69,5	72,4
	16R	VOE 17493101	80,2	86,2
	21R	VOE 17493102	84,4	96
	31R	VOE 17493103	97,2	101,9
	41R	VOE 17493104	105,5	111,4
	56R	VOE 17493105	114,3	123,4
	66R	VOE 17493106	130	136,1
	81R	VOE14740816	134,9	145,1
	126R	VOE14740818	155,1	166,8



Tool	Designation	Part No	Weight (kg)	Sizes
	11\126T	VOE 17473120	3	11\126



## Wheel Loaders

### L60

Teeth/Adapters	Description	Part No.	Designation	Type/application	Weight kg
	ADAPTER	VOE 17491920	LA11FC25	Flush-mounted	4,3
		VOE 17491921	LA11TL25	Top Leg	4,17
		VOE 17491915	LA11BN25	Bolt-on	5,5
	TOOTH	VOE 17491940	11GPL	General purpose	2,7
	PIN	VOE 17473100	11P	Locking device	0,2
	RETAINER	VOE 17493100	11R	Retainer (if tooth is ordered, retainer is included)	
	HEXAGON SCREW	VOE 997464	M16 L=70mm		
	FLANGE NUT	VOE 60113144	M16		
<b>Shim for bolted adapter</b>	<b>Part No.</b>	<b>Thickness mm</b>	<b>Width mm</b>	<b>Length mm</b>	<b>Note</b>
	VOE 15015573	1	80	175.5	Requisite number
	VOE 15015574	2	80	175.5	Requisite number
	VOE 15015576	3	80	175.5	Requisite number

### L70

Teeth/Adapters	Description	Part No.	Designation	Type/application	Weight kg
	ADAPTER	VOE 17491920	LA11FC25	Flush-mounted	4,3
		VOE 17491921	LA11TL25	Top Leg	4,17
		VOE 17491915	LA11BN25	Bolt-on	5,5
	TOOTH	VOE 17491940	11GPL	General purpose	2,7
	PIN	VOE 17473100	11P	Locking device	0,2
	RETAINER	VOE 17493100	11R	Retainer (if tooth is ordered, retainer is included)	
	HEXAGON SCREW	VOE 997464	M16 L=70mm		
	FLANGE NUT	VOE 60113144	M16		
<b>Shim for bolted adapter</b>	<b>Part No.</b>	<b>Thickness mm</b>	<b>Width mm</b>	<b>Length mm</b>	<b>Note</b>
	VOE 15015573	1	80	175.5	Requisite number
	VOE 15015574	2	80	175.5	Requisite number
	VOE 15015576	3	80	175.5	Requisite number

### L90

Teeth/Adapters	Description	Part No.	Designation	Type/application	Weight kg
	ADAPTER	VOE 17491922	LA16FC30-35	Flush-mounted	6,5
		VOE 17491923	LA16TL30	Top Leg	6,7
		VOE 17491916	LA16BN30	Bolt-on	7,2
	TOOTH	VOE 17491941	16GPL	General purpose	4,1
		VOE 17491942	16AML	Abrasive material	4,9
		VOE 17491943	16AMRL	Abrasive material with extra wear metal	5,7
	PIN	VOE 17473101	16P	Locking device	0,2
	RETAINER	VOE 17493101	16R	Retainer	
	HEXAGON SCREW	VOE 963361	M24 L=100mm		
	LOCK NUT	VOE 948836	M24		
	WASHER	VOE 997387			
<b>Shim for bolted adapter</b>	<b>Part No.</b>	<b>Thickness mm</b>	<b>Width mm</b>	<b>Length mm</b>	<b>Note</b>
	VOE 15015573	1	80	175.5	Requisite number
	VOE 15015574	2	80	175.5	Requisite number
	VOE 15015576	3	80	175.5	Requisite number

## L110

Teeth/Adapters	Description	Part No.	Designation	Type/application	Weight kg
	ADAPTER	VOE 17491918	LA21BN40	Bolt-on	8,3
		VOE 17491925	LA21TL35	Top Leg	8,3
	TOOTH	VOE 17491944	21GPL	General purpose	6
		VOE 17491945	21AML	Abrasive material	6,3
		VOE 17491946	21AMRL	Abrasive material with extra wear metal	8,28
	PIN	VOE 17473102	21P	Locking device	0,2
	RETAINER	VOE 17493102	21R	Retainer	
	HEXAGON SCREW	VOE 963361	M24 L=100mm		
	LOCK NUT	VOE 948836	M24		
	WASHER	VOE 997387			
Shim for bolted adapter	Part No.	Thickness mm	Width mm	Length mm	Note
	VOE 15015573	1	80	175.5	Requisite number
	VOE 15015574	2	80	175.5	Requisite number
	VOE 15015576	3	80	175.5	Requisite number

## L120

Teeth/Adapters	Description	Part No.	Designation	Type/application	Weight kg
	ADAPTER	VOE 17491918	LA21BN40	Bolt-on	8,3
		VOE 17491925	LA21TL35	Top Leg	8,3
	TOOTH	VOE 17491944	21GPL	General purpose	6
		VOE 17491945	21AML	Abrasive material	6,3
		VOE 17491946	21AMRL	Abrasive material with extra wear metal	8,28
	PIN	VOE 17473102	21P	Locking device	0,2
	RETAINER	VOE 17493102	21R	Retainer	
	HEXAGON SCREW	VOE 963361	M24 L=100mm		
	LOCK NUT	VOE 948836	M24		
	WASHER	VOE 997387			
Shim for bolted adapter	Part No.	Thickness mm	Width mm	Length mm	Note
	VOE 15015573	1	80	175.5	Requisite number
	VOE 15015574	2	80	175.5	Requisite number
	VOE 15015576	3	80	175.5	Requisite number

**L150**

Teeth/Adapters	Description	Part No.	Designation	Type/application	Weight kg
	ADAPTER	VOE 17491926	LA21FC40	Flush-mounted	9,55
		VOE 17491927	LA21TL40	Top Leg	8,47
		VOE 17491918	LA21BN40	Bolt-on	15,4
	TOOTH	VOE 17491944	21GPL	General purpose	6
		VOE 17491945	21AML	Abrasive material	6,3
		VOE 17491946	21AMRL	Abrasive material with extra wear metal	8,3
	PIN	VOE 17473102	21P	Locking device	0,2
	RETAINER	VOE 17493102	21R	Retainer	
	HEXAGON SCREW	VOE 963361	M24 L=100mm		
	LOCK NUT	VOE 948836	M24		
	WASHER	VOE 997387			
Teeth/Adapters	Description	Part No.	Designation	Type/application	Weight kg
	ADAPTER	VOE 17491928	LA31FC40	Flush-mounted	13,6
		VOE 17491929	LA31TL40	Top Leg	11,6
		VOE 17491919	LA31BN40	Bolt-on	19,1
	TOOTH	VOE 17491947	31GPL	General purpose	8
		VOE 17491948	31AML	Abrasive material	8,8
		VOE 17491949	31AMRL	Abrasive material with extra wear metal	11,5
	PIN	VOE 17473103	31P	Locking device	0,3
	RETAINER	VOE 17493103	31R	Retainer	
	HEXAGON SCREW	VOE 963361	M24 L=100mm		
	LOCK NUT	VOE 948836	M24		
	WASHER	VOE 997387			
Shim for bolted adapter	Part No.	Thickness mm	Width mm	Length mm	Note
	VOE 15015573	1	80	175.5	Requisite number
	VOE 15015574	2	80	175.5	Requisite number
	VOE 15015576	3	80	175.5	Requisite number

L180

Teeth/Adapters	Description	Part No.	Designation	Type/application	Weight kg
	ADAPTER	VOE 17491926	LA21FC40	Flush-mounted	9,55
		VOE 17491927	LA21TL40	Top Leg	8,47
		VOE 17491918			
	TOOTH	VOE 17491944	21GPL	General purpose	6
		VOE 17491945	21AML	Abrasive material	6,3
		VOE 17491946	21AMRL	Abrasive material with extra wear metal	8,3
	PIN	VOE 17473102			
	RETAINER	VOE 17493102			
	HEXAGON SCREW	VOE 963361	M24 L=100mm		
	LOCK NUT	VOE 948836	M24		
	WASHER	VOE 997387			
Teeth/Adapters	Description	Part No.	Designation	Type/application	Weight kg
	ADAPTER	VOE 17491928	LA31FC40	Flush-mounted	13,6
		VOE 17491929	LA31TL40	Top Leg	11,6
		VOE 17491919	LA31BN40	Bolt-on	19,1
	TOOTH	VOE 17491947	31GPL	General purpose	8
		VOE 17491948	31AML	Abrasive material	8,8
		VOE 17491949	31AMRL	Abrasive material with extra wear metal	11,5
	PIN	VOE 17473103	31P	Locking device	0,3
	RETAINER	VOE 17493103	31R	Retainer	
	HEXAGON SCREW	VOE 963361	M24 L=100mm		
	LOCK NUT	VOE 948836	M24		
	WASHER	VOE 997387			
Shim for bolted adapter	Part No.	Thickness mm	Width mm	Length mm	Note
	VOE 15015573	1	80	175.5	Requisite number
	VOE 15015574	2	80	175.5	Requisite number
	VOE 15015576	3	80	175.5	Requisite number

L220

Teeth/Adapters	Description	Part No.	Designation	Type/application	Weight kg
	ADAPTER	VOE 17491928	LA31FC40	Flush-mounted	13,6
		VOE 17491929	LA31TL40	Top Leg	11,6
		VOE 17491919	LA31BN40	Bolt-on	19,1
	TOOTH	VOE 17491947	31GPL	General purpose	8
		VOE 17491948	31AML	Abrasive material	8,8
		VOE 17491949	31AMRL	Abrasive material with extra wear metal	11,5
	PIN	VOE 17473103	31P	Locking device	0,3
	RETAINER	VOE 17493103	31R	Retainer	
	HEXAGON SCREW	VOE 963361	M24 L=100mm		
	LOCK NUT	VOE 948836	M24		
	WASHER	VOE 997387			
Teeth/Adapters	Description	Part No.	Designation	Type/application	Weight kg
	ADAPTER	VOE 17491930	LA41TL40	Top Leg	15,8
		VOE 17491933	LA41TL50	Top Leg	16,6
	TOOTH	VOE 17491950	41GPL	General purpose	11
		VOE 17491951	41AMRL	Abrasive material with extra wear metal	17,1
	PIN	VOE 17473104	41P	Locking device	0,4
	RETAINER	VOE 17493104	41R	Retainer	
Shim for bolted adapter	Part No.	Thickness mm	Width mm	Length mm	Note
	VOE 15015573	1	80	175.5	Requisite number
	VOE 15015574	2	80	175.5	Requisite number
	VOE 15015576	3	80	175.5	Requisite number

### L250

Teeth/Adapters	Description	Part No.	Designation	Type/application	Weight kg
	ADAPTER	VOE 17491930	LA41TL40	Top Leg	15,8
		VOE 17491933	LA41TL50	Top Leg	16,6
	TOOTH	VOE 17491950	41GPL	General purpose	11
		VOE 17491951	41AMRL	Abrasive material with extra wear metal	17,1
	PIN	VOE 17473104	41P	Locking device	0,4
	RETAINER	VOE 17493104	41R	Retainer	

### L260

Teeth/Adapters	Description	Part No.	Designation	Type/application	Weight kg
	ADAPTER	VOE 17491930	LA41TL40	Top Leg	15,8
		VOE 17491933	LA41TL50	Top Leg	16,6
	TOOTH	VOE 17491950	41GPL	General purpose	11
		VOE 17491951	41AMRL	Abrasive material with extra wear metal	17,1
	PIN	VOE 17473104	41P	Locking device	0,4
	RETAINER	VOE 17493104	41R	Retainer	

### L330

Teeth/Adapters	Description	Part No.	Designation	Type/application	Weight kg
	ADAPTER	VOE 17491931	LA56TL65	Top Leg	22,7
	TOOTH	VOE 17491952	56AMRL	Abrasive material with extra wear metal	22,9
	PIN	VOE 17473105	56P	Locking device	0,56
	RETAINER	VOE 17493105	56R	Retainer	
Teeth/Adapters	Description	Part No.	Designation	Type/application	Weight kg
	ADAPTER	VOE 17491932	LA66TL65	Top Leg	32,6
	TOOTH	VOE 17491953	66AMRL	Abrasive material with extra wear metal	28,4
	PIN	VOE 17473106	66P	Locking device	0,8
	RETAINER	VOE 17493106	66R	Retainer	

### L350

Teeth/Adapters	Description	Part No.	Designation	Type/application	Weight kg
	ADAPTER	VOE 17491931	LA56TL65	Top Leg	22,7
	TOOTH	VOE 17491952	56AMRL	Abrasive material with extra wear metal	22,9
	PIN	VOE 17473105	56P	Locking device	0,56
	RETAINER	VOE 17493105	56R	Retainer	
Teeth/Adapters	Description	Part No.	Designation	Type/application	Weight kg
	ADAPTER	VOE 17491932	LA66TL65	Top Leg	32,6
	TOOTH	VOE 17491953	66AMRL	Abrasive material with extra wear metal	28,37
	PIN	VOE 17473106	66p	Locking device	0,8
	RETAINER	VOE 17493106	66R	Retainer	

Crawler Excavators

EC140

Teeth/Adapters	Description	Part No.	Designation	Type/application	Weight kg
	ADAPTER	VOE 17491921	EA11TL25	Top Leg	4,8
		VOE 14744545	EA11TL30	Top Leg	4,2
	TOOTH	VOE 14744546	11GPE	General purpose	2,7
		VOE 14744547	11ARXE	Abrasive material with extra wear metal	3,2
	PIN	VOE 17473100	11P	Locking device	0,2
	RETAINER	VOE 17493100	11R	Retainer	
Teeth/Adapters	Description	Part No.	Designation	Type/application	Weight kg
	ADAPTER	VOE 14727403	EA16TL30	Top Leg	6,8
	TOOTH	VOE 14732376	16GPE	General purpose	4,1
		VOE 14732377	16ARXE	Abrasive material with extra wear metal	4,7
		VOE 14732378	16PPE	Extremely compact material	3,6
		VOE 14732379	16TPE	Extremely compact material	4
		VOE 14732380	16SNE	Levelling, cleaning, grading and backfilling	4,9
	PIN	VOE 17473101	16P	Locking device	0,2
	RETAINER	VOE 17493101	16R	Retainer	

ECR145

Teeth/Adapters	Description	Part No.	Designation	Type/application	Weight kg
	ADAPTER	VOE 17491921	EA11TL25	Top Leg	4,8
		VOE 14744545	EA11TL30	Top Leg	4,2
	TOOTH	VOE 14744546	11GPE	General purpose	2,7
		VOE 14744547	11ARXE	Abrasive material with extra wear metal	3,2
	PIN	VOE 17473100	11P	Locking device	0,2
	RETAINER	VOE 17493100	11R	Retainer	
Teeth/Adapters	Description	Part No.	Designation	Type/application	Weight kg
	ADAPTER	VOE 14727403	EA16TL30	Top Leg	6,8
	TOOTH	VOE 14732376	16GPE	General purpose	4,1
		VOE 14732377	16ARXE	Abrasive material with extra wear metal	4,7
		VOE 14732378	16PPE	Extremely compact material	3,6
		VOE 14732379	16TPE	Extremely compact material	4
		VOE 14732380	16SNE	Levelling, cleaning, grading and backfilling	4,9
	PIN	VOE 17473101	16P	Locking device	0,2
	RETAINER	VOE 17493101	16R	Retainer	

## EC160

Teeth/Adapters	Description	Part No.	Designation	Type/application	Weight kg
	ADAPTER	VOE 14727403	EA16TL30	Top Leg	6,8
	TOOTH	VOE 14732376	16GPE	General purpose	4,1
		VOE 14732377	16ARXE	Abrasive material with extra wear metal	4,7
		VOE 14732378	16PPE	Extremely compact material	3,6
		VOE 14732379	16TPE	Extremely compact material	4
		VOE 14732380	16SNE	Levelling, cleaning, grading and backfilling	4,9
	PIN	VOE 17473101	16P	Locking device	0,2
	RETAINER	VOE 17493101	16R	Retainer	
Teeth/Adapters	Description	Part No.	Designation	Type/application	Weight kg
	ADAPTER	VOE 14727405	EA21TL40	Top Leg	10
	TOOTH	VOE 14732381	21GPE	General purpose	6
		VOE 14732382	21ARXE	Abrasive material with extra wear metal	6,9
		VOE 14732383	21PPE	Extremely compact material	4,9
		VOE 14732384	21TPE	Extremely compact material	6,2
		VOE 14732385	21SNE	Levelling, cleaning, grading and backfilling	8
	PIN	VOE 17473102	21P	Locking device	0,2
	RETAINER	VOE 17493102	21R	Retainer	

## EC180

Teeth/Adapters	Description	Part No.	Designation	Type/application	Weight kg
	ADAPTER	VOE 14727403	EA16TL30	Top Leg	6,8
	TOOTH	VOE 14732376	16GPE	General purpose	4,1
		VOE 14732377	16ARXE	Abrasive material with extra wear metal	4,7
		VOE 14732378	16PPE	Extremely compact material	3,6
		VOE 14732379	16TPE	Extremely compact material	4
		VOE 14732380	16SNE	Levelling, cleaning, grading and backfilling	4,9
	PIN	VOE 17473101	16P	Locking device	0,2
	RETAINER	VOE 17493101	16R	Retainer	
Teeth/Adapters	Description	Part No.	Designation	Type/application	Weight kg
	ADAPTER	VOE 14727405	EA21TL40	Top Leg	10
	TOOTH	VOE 14732381	21GPE	General purpose	6
		VOE 14732382	21ARXE	Abrasive material with extra wear metal	6,9
		VOE 14732383	21PPE	Extremely compact material	4,9
		VOE 14732384	21TPE	Extremely compact material	6,2
		VOE 14732385	21SNE	Levelling, cleaning, grading and backfilling	8
	PIN	VOE 17473102	21P	Locking device	0,2
	RETAINER	VOE 17493102	21R	Retainer	
	TOOL	VOE 17473120	11/126T	Tool	3

## EC200

Teeth/Adapters	Description	Part No.	Designation	Type/application	Weight kg
	ADAPTER	VOE 14727405	EA21TL40	Top Leg	10
	TOOTH	VOE 14732381	21GPE	General purpose	6
	TOOTH	VOE 14732382	21ARXE	Abrasive material with extra wear metal	6,9
	TOOTH	VOE 14732383	21PPE	Extremely compact material	4,9
	TOOTH	VOE 14732384	21TPE	Extremely compact material	6,2
	TOOTH	VOE 14732385	21SNE	Levelling, cleaning, grading and backfilling	8
	PIN	VOE 17473102	21P	Locking device	0,2
	RETAINER	VOE 17493102	21R	Retainer	
	TOOL	VOE 17473120	11/126T	Tool	3
Teeth/Adapters	Description	Part No.	Designation	Type/application	Weight kg
	ADAPTER	VOE 14727406	EA31TL40	Top Leg	12,7
	TOOTH	VOE 14732386	31GPE	General purpose	7,8
	TOOTH	VOE 14732387	31ARXE	Abrasive material with extra wear metal	8,9
	TOOTH	VOE 45099788	31SNE	Levelling, cleaning, grading and backfilling	9,8
	PIN	VOE 17473103	31P	Locking device	0,3
	RETAINER	VOE 17493103	31R	Retainer	

## EC210

Teeth/Adapters	Description	Part No.	Designation	Type/application	Weight kg
	ADAPTER	VOE 14727405	EA21TL40	Top Leg	10
	TOOTH	VOE 14732381	21GPE	General purpose	6
	TOOTH	VOE 14732382	21ARXE	Abrasive material with extra wear metal	6,9
	TOOTH	VOE 14732383	21PPE	Extremely compact material	4,9
	TOOTH	VOE 14732384	21TPE	Extremely compact material	6,2
	TOOTH	VOE 14732385	21SNE	Levelling, cleaning, grading and backfilling	8
	PIN	VOE 17473102	21P	Locking device	0,2
	RETAINER	VOE 17493102	21R	Retainer	
	TOOL	VOE 17473120	11/126T	Tool	3
Teeth/Adapters	Description	Part No.	Designation	Type/application	Weight kg
	ADAPTER	VOE 14727406	EA31TL40	Top Leg	12,7
	TOOTH	VOE 14732386	31GPE	General purpose	7,8
	TOOTH	VOE 14732387	31ARXE	Abrasive material with extra wear metal	8,9
	TOOTH	VOE 45099788	31SNE	Levelling, cleaning, grading and backfilling	9,8
	PIN	VOE 17473103	31P	Locking device	0,3
	RETAINER	VOE 17493103	31R	Retainer	



**EC220**

Teeth/Adapters	Description	Part No.	Designation	Type/application	Weight kg
	ADAPTER	VOE 14727405	EA21TL40	Top Leg	10
	TOOTH	VOE 14732381	21GPE	General purpose	6
	TOOTH	VOE 14732382	21ARXE	Abrasive material with extra wear metal	6,9
	TOOTH	VOE 14732383	21PPE	Extremely compact material	4,9
	TOOTH	VOE 14732384	21TPE	Extremely compact material	6,2
	TOOTH	VOE 14732385	21SNE	Levelling, cleaning, grading and backfilling	8
	PIN	VOE 17473102	21P	Locking device	0,2
	RETAINER	VOE 17493102	21R	Retainer	
	TOOL	VOE 17473120	11/126T	Tool	3
Teeth/Adapters	Description	Part No.	Designation	Type/application	Weight kg
	ADAPTER	VOE 14727406	EA31TL40	Top Leg	12,7
	TOOTH	VOE 14732386	31GPE	General purpose	7,8
	TOOTH	VOE 14732387	31ARXE	Abrasive material with extra wear metal	8,9
	TOOTH	VOE 45099788	31SNE	Levelling, cleaning, grading and backfilling	9,8
	PIN	VOE 17473103	31P	Locking device	0,3
	RETAINER	VOE 17493103	31R	Retainer	

**EC230 Electric**

Teeth/Adapters	Description	Part No.	Designation	Type/application	Weight kg
	ADAPTER	VOE 14727405	EA21TL40	Top Leg	10
	TOOTH	VOE 14732381	21GPE	General purpose	6
	TOOTH	VOE 14732382	21ARXE	Abrasive material with extra wear metal	6,9
	TOOTH	VOE 14732383	21PPE	Extremely compact material	4,9
	TOOTH	VOE 14732384	21TPE	Extremely compact material	6,2
	TOOTH	VOE 14732385	21SNE	Levelling, cleaning, grading and backfilling	8
	PIN	VOE 17473102	21P	Locking device	0,2
	RETAINER	VOE 17493102	21R	Retainer	
	TOOL	VOE 17473120	11/126T	Tool	3
Teeth/Adapters	Description	Part No.	Designation	Type/application	Weight kg
	ADAPTER	VOE 14727406	EA31TL40	Top Leg	12,7
	TOOTH	VOE 14732386	31GPE	General purpose	7,8
	TOOTH	VOE 14732387	31ARXE	Abrasive material with extra wear metal	8,9
	TOOTH	VOE 45099788	31SNE	Levelling, cleaning, grading and backfilling	9,8
	PIN	VOE 17473103	31P	Locking device	0,3
	RETAINER	VOE 17493103	31R	Retainer	

**EC235**

Teeth/Adapters	Description	Part No.	Designation	Type/application	Weight kg
	ADAPTER	VOE 14727405	EA21TL40	Top Leg	10
	TOOTH	VOE 14732381	21GPE	General purpose	6
	TOOTH	VOE 14732382	21ARXE	Abrasive material with extra wear metal	6,9
	TOOTH	VOE 14732383	21PPE	Extremely compact material	4,9
	TOOTH	VOE 14732384	21TPE	Extremely compact material	6,2
	TOOTH	VOE 14732385	21SNE	Levelling, cleaning, grading and backfilling	8
	PIN	VOE 17473102	21P	Locking device	0,2
	RETAINER	VOE 17493102	21R	Retainer	
	TOOL	VOE 17473120	11/126T	Tool	3
Teeth/Adapters	Description	Part No.	Designation	Type/application	Weight kg
	ADAPTER	VOE 14727406	EA31TL40	Top Leg	12,7
	TOOTH	VOE 14732386	31GPE	General purpose	7,8
	TOOTH	VOE 14732387	31ARXE	Abrasive material with extra wear metal	8,9
	TOOTH	VOE 45099788	31SNE	Levelling, cleaning, grading and backfilling	9,8
	PIN	VOE 17473103	31P	Locking device	0,3
	RETAINER	VOE 17493103	31R	Retainer	

**ECR235**

Teeth/Adapters	Description	Part No.	Designation	Type/application	Weight kg
	ADAPTER	VOE 14727405	EA21TL40	Top Leg	10
	TOOTH	VOE 14732381	21GPE	General purpose	6
	TOOTH	VOE 14732382	21ARXE	Abrasive material with extra wear metal	6,9
	TOOTH	VOE 14732383	21PPE	Extremely compact material	4,9
	TOOTH	VOE 14732384	21TPE	Extremely compact material	6,2
	TOOTH	VOE 14732385	21SNE	Levelling, cleaning, grading and backfilling	8
	PIN	VOE 17473102	21P	Locking device	0,2
	RETAINER	VOE 17493102	21R	Retainer	
	TOOL	VOE 17473120	11/126T	Tool	3
Teeth/Adapters	Description	Part No.	Designation	Type/application	Weight kg
	ADAPTER	VOE 14727406	EA31TL40	Top Leg	12,7
	TOOTH	VOE 14732386	31GPE	General purpose	7,8
	TOOTH	VOE 14732387	31ARXE	Abrasive material with extra wear metal	8,9
	TOOTH	VOE 45099788	31SNE	Levelling, cleaning, grading and backfilling	9,8
	PIN	VOE 17473103	31P	Locking device	0,3
	RETAINER	VOE 17493103	31R	Retainer	

## EC250

Teeth/Adapters	Description	Part No.	Designation	Type/application	Weight kg
	ADAPTER	VOE 14727406	EA31TL40	Top Leg	12,7
	TOOTH	VOE 14732386	31GPE	General purpose	7,8
	TOOTH	VOE 14732387	31ARXE	Abrasive material with extra wear metal	8,9
	TOOTH	VOE 45099788	31SNE	Levelling, cleaning, grading and backfilling	9,8
	PIN	VOE 17473103	31P	Locking device	0,3
	RETAINER	VOE 17493103	31R	Retainer	
Teeth/Adapters	Description	Part No.	Designation	Type/application	Weight kg
	ADAPTER	VOE 14727409	EA41TLW40	Top Leg	19,6
	ADAPTER	VOE 14732187	EA41TLW50	Top Leg	19,5
	TOOTH	VOE 14732391	41GPE	General purpose	10
	TOOTH	VOE 14732392	41ARXE	Abrasive material with extra wear metal	12,2
	TOOTH	VOE 14732393	41PPE	Extremely compact material	8,7
	TOOTH	VOE 14732394	41TPE	Extremely compact material	10,7
	TOOTH	VOE 14732395	41SNE	Levelling, cleaning, grading and backfilling	13,1
	PIN	VOE 17473104	41P	Locking device	0,4
	RETAINER	VOE 17493104	41R	Retainer	
	CAP	VOE 14736109	41W	Wear cap	2

## EC300

Teeth/Adapters	Description	Part No.	Designation	Type/application	Weight kg
	ADAPTER	VOE 14727409	EA41TLW40	Top Leg	19,6
		VOE 14732187	EA41TLW50	Top Leg	19,5
	TOOTH	VOE 14732391	41GPE	General purpose	10
		VOE 14732392	41ARXE	Abrasive material with extra wear metal	12,2
		VOE 14732393	41PPE	Extremely compact material	8,7
		VOE 14732394	41TPE	Extremely compact material	10,7
		VOE 14732395	41SNE	Levelling, cleaning, grading and backfilling	13,1
	PIN	VOE 17473104	41P	Locking device	0,4
	RETAINER	VOE 17493104	41R	Retainer	
	CAP	VOE 14736109	41W	Wear cap	2
Teeth/Adapters	Description	Part No.	Designation	Type/application	Weight kg
	ADAPTER	VOE 14732190	EA56TLW50	Top Leg	26,6
	TOOTH	VOE 14732396	56GPE	General purpose	13,7
		VOE 14732397	56ARXE	Abrasive material with extra wear metal	16,8
		VOE 14732398	56PPE	Extremely compact material	11,6
		VOE 14732399	56TPE	Extremely compact material	15
		VOE 14732400	56SNE	Levelling, cleaning, grading and backfilling	18,2
	PIN	VOE 17473105	56P	Locking device	0,5
	RETAINER	VOE 17493105	56R	Retainer	
	CAP	VOE 14736110	56W	Wear cap	2,2

EC350

Teeth/Adapters	Description	Part No.	Designation	Type/application	Weight kg
	ADAPTER	VOE 14732190	EA56TLW50	Top Leg	26,6
	TOOTH	VOE 14732396	56GPE	General purpose	13,7
	TOOTH	VOE 14732397	56ARXE	Abrasive material with extra wear metal	16,8
	TOOTH	VOE 14732398	56PPE	Extremely compact material	11,6
	TOOTH	VOE 14732399	56TPE	Extremely compact material	15
	TOOTH	VOE 14732400	56SNE	Levelling, cleaning, grading and backfilling	18,2
	PIN	VOE 17473105	56P	Locking device	0,5
	RETAINER	VOE 17493105	56R	Retainer	
	CAP	VOE 14736110	56W	Wear cap	2,2
Teeth/Adapters	Description	Part No.	Designation	Type/application	Weight kg
	ADAPTER	VOE 14732191	EA66TLW50	Top Leg	38,2
	ADAPTER	VOE 14732192	EA66TLW60	Top Leg	37,4
	TOOTH	VOE 14732401	66GPE	General purpose	16,6
	TOOTH	VOE 14732402	66ARXE	Abrasive material with extra wear metal	22,5
	TOOTH	VOE 14732403	66PPE	Extremely compact material	15
	TOOTH	VOE 54099789	66SNE	Levelling, cleaning, grading and backfilling	24,7
	PIN	VOE 17473106	66P	Locking device	0,3
	RETAINER	VOE 17493106	66R	Retainer	
	CAP	VOE 14736111	66W	Wear cap	3,5
	TOOL	VOE 17473120	11/126T	Tool	3

ECR355

Teeth/Adapters	Description	Part No.	Designation	Type/application	Weight kg
	ADAPTER	VOE 14727409	EA41TLW40	Top Leg	19,6
	ADAPTER	VOE 14732187	EA41TLW50	Top Leg	19,5
	TOOTH	VOE 14732391	41GPE	General purpose	10
	TOOTH	VOE 14732392	41ARXE	Abrasive material with extra wear metal	12,2
	TOOTH	VOE 14732393	41PPE	Extremely compact material	8,7
	TOOTH	VOE 14732394	41TPE	Extremely compact material	10,7
	TOOTH	VOE 14732395	41SNE	Levelling, cleaning, grading and backfilling	13,1
	PIN	VOE 17473104	41P	Locking device	0,4
	RETAINER	VOE 17493104	41R	Retainer	
	CAP	VOE 14736109	41W	Wear cap	2
Teeth/Adapters	Description	Part No.	Designation	Type/application	Weight kg
	ADAPTER	VOE 14732190	EA56TLW50	Top Leg	26,6
	TOOTH	VOE 14732396	56GPE	General purpose	13,7
	TOOTH	VOE 14732397	56ARXE	Abrasive material with extra wear metal	16,8
	TOOTH	VOE 14732398	56PPE	Extremely compact material	11,6
	TOOTH	VOE 14732399	56TPE	Extremely compact material	15
	TOOTH	VOE 14732400	56SNE	Levelling, cleaning, grading and backfilling	18,2
	PIN	VOE 17473105	56P	Locking device	0,5
	RETAINER	VOE 17493105	56R	Retainer	
	CAP	VOE 14736110	56W	Wear cap	2,2

**EC380**

Teeth/Adapters	Description	Part No.	Designation	Type/application	Weight kg
	ADAPTER	VOE 14732190	EA56TLW50	Top Leg	26,6
	TOOTH	VOE 14732396	56GPE	General purpose	13,7
	TOOTH	VOE 14732397	56ARXE	Abrasive material with extra wear metal	16,8
	TOOTH	VOE 14732398	56PPE	Extremely compact material	11,6
	TOOTH	VOE 14732399	56TPE	Extremely compact material	15
	TOOTH	VOE 14732400	56SNE	Levelling, cleaning, grading and backfilling	18,2
	PIN	VOE 17473105	56P	Locking device	0,5
	RETAINER	VOE 17493105	56R	Retainer	
	CAP	VOE 14736110	56W	Wear cap	2,2
Teeth/Adapters	Description	Part No.	Designation	Type/application	Weight kg
	ADAPTER	VOE 14732191	EA66TLW50	Top Leg	38,2
	ADAPTER	VOE 14732192	EA66TLW60	Top Leg	37,4
	TOOTH	VOE 14732401	66GPE	General purpose	16,6
	TOOTH	VOE 14732402	66ARXE	Abrasive material with extra wear metal	22,5
	TOOTH	VOE 14732403	66PPE	Extremely compact material	15
	TOOTH	VOE 54099789	66SNE	Levelling, cleaning, grading and backfilling	24,7
	PIN	VOE 17473106	66P	Locking device	0,3
	RETAINER	VOE 17493106	66R	Retainer	
	CAP	VOE 14736111	66W	Wear cap	3,5
	TOOL	VOE 17473120	11/126T	Tool	3

**EC480 D, E**

Teeth/Adapters	Description	Part No.	Designation	Type/application	Weight kg
	ADAPTER	VOE 14732191	EA66TLW50	Top Leg	38,2
	ADAPTER	VOE 14732192	EA66TLW60	Top Leg	37,4
	TOOTH	VOE 14732401	66GPE	General purpose	16,6
	TOOTH	VOE 14732402	66ARXE	Abrasive material with extra wear metal	22,5
	TOOTH	VOE 14732403	66PPE	Extremely compact material	15
	TOOTH	VOE 54099789	66SNE	Levelling, cleaning, grading and backfilling	24,7
	PIN	VOE 17473106	66P	Locking device	0,3
	RETAINER	VOE 17493106	66R	Retainer	
	CAP	VOE 14736111	66W	Wear cap	3,5
	TOOL	VOE 17473120	11/126T	Tool	3
Teeth/Adapters	Description	Part No.	Designation	Type/application	Weight kg
	ADAPTER	VOE 14732193	EA81TLW80	Top Leg	45,1
	TOOTH	VOE 14732404	81GPE	General purpose	23,1
	TOOTH	VOE14731779	81ARXE	Abrasive material with extra wear metal	29,5
	TOOTH	VOE14732424	81PPE	Extremely compact material	20
	LOCK	VOE 14740815	81P	Locking device	0,9
	RETAINER	VOE14740816	81R	Retainer	
	WEAR CAP	VOE14736112	81W	Adapter protector	4,3
	TOOL	VOE 17473120	11/126T	Tool	3

**EC530**

Teeth/Adapters	Description	Part No.	Designation	Type/application	Weight kg
	ADAPTER	VOE 14732191	EA66TLW50	Top Leg	38,2
	ADAPTER	VOE 14732192	EA66TLW60	Top Leg	37,4
	TOOTH	VOE 14732401	66GPE	General purpose	16,6
	TOOTH	VOE 14732402	66ARXE	Abrasive material with extra wear metal	22,5
	TOOTH	VOE 14732403	66PPE	Extremely compact material	15
	TOOTH	VOE 54099789	66SNE	Levelling, cleaning, grading and backfilling	24,7
	PIN	VOE 17473106	66P	Locking device	0,3
	RETAINER	VOE 17493106	66R	Retainer	
	CAP	VOE 14736111	66W	Wear cap	3,5
	TOOL	VOE 17473120	11/126T	Tool	3

**EC550**

Teeth/Adapters	Description	Part No.	Designation	Type/application	Weight kg
	ADAPTER	VOE 14732191	EA66TLW50	Top Leg	38,2
		VOE 14732192	EA66TLW60	Top Leg	37,4
	TOOTH	VOE 14732401	66GPE	General purpose	16,6
		VOE 14732402	66ARXE	Abrasive material with extra wear metal	22,5
		VOE 14732403	66PPE	Extremely compact material	15
	TOOTH	VOE 54099789	66SNE	Levelling, cleaning, grading and backfilling	24,7
	PIN	VOE 17473106	66P	Locking device	0,3
	RETAINER	VOE 17493106	66R	Retainer	
	CAP	VOE 14736111	66W	Wear cap	3,5
	TOOL	VOE 17473120	11/126T	Tool	3
Teeth/Adapters	Description	Part No.	Designation	Type/application	Weight kg
	ADAPTER	VOE 14732193	EA81TLW80	Top Leg	45,1
	TOOTH	VOE 14732404	81GPE	General purpose	23,1
	TOOTH	VOE14731779	81ARXE	Abrasive material with extra wear metal	29,5
	TOOTH	VOE14732424	81PPE	Extremely compact material	20
	LOCK	VOE 14740815	81P	Locking device	0,9
	RETAINER	VOE14740816	81R	Retainer	
	WEAR CAP	VOE14736112	81W	Adapter protector	4,3
	TOOL	VOE 17473120	11/126T	Tool	3

### EC700

Teeth/Adapters	Description	Part No.	Designation	Type/application	Weight kg
	ADAPTER	VOE 14732193	EA81TLW80	Top Leg	45,1
	TOOTH	VOE 14732404	81GPE	General purpose	23,1
	TOOTH	VOE14731779	81ARXE	Abrasive material with extra wear metal	29,5
	TOOTH	VOE14732424	81PPE	Extremely compact material	20
	LOCK	VOE 14740815	81P	Locking device	0,9
	RETAINER	VOE14740816	81R	Retainer	
	WEAR CAP	VOE14736112	81W	Adapter protector	4,3
	TOOL	VOE 17473120	11/126T	Tool	3

### EC750

Teeth/Adapters	Description	Part No.	Designation	Type/application	Weight kg
	ADAPTER	VOE 14732193	EA81TLW80	Top Leg	45,1
	TOOTH	VOE 14732404	81GPE	General purpose	23,1
	TOOTH	VOE14731779	81ARXE	Abrasive material with extra wear metal	29,5
	TOOTH	VOE14732424	81PPE	Extremely compact material	20
	LOCK	VOE 14740815	81P	Locking device	0,9
	RETAINER	VOE14740816	81R	Retainer	
	WEAR CAP	VOE14736112	81W	Adapter protector	4,3
	TOOL	VOE 17473120	11/126T	Tool	3
Teeth/Adapters	Description	Part No.	Designation	Type/application	Weight kg
	ADAPTER	VOE 14732375	EA126TLW10	Top Leg	73,1
	ADAPTER	VOE14732194	EA126TLW90	Top Leg	73,4
	TOOTH	VOE14732425	126ARXE	Abrasive material with extra wear metal	43,2
	TOOTH	VOE14753794	126PPE	Extremely compacted material	35
	WEAR CAP	VOE14736113	126W	Adapter protector	6,6
	PIN	VOE14740817	126P	Locking device	1,4
	RETAINER	VOE14740818	126R	Retainer	

### EC950

Teeth/Adapters	Description	Part No.	Designation	Type/application	Weight kg
	ADAPTER	VOE 14732375	EA126TLW100	Top Leg	73,1
	ADAPTER	VOE14732194	EA126TLW90	Top Leg	73,4
	TOOTH	VOE14732425	126ARXE	Abrasive material with extra wear metal	43,2
	TOOTH	VOE14753794	126PPE	Extremely compacted material	35
	WEAR CAP	VOE14736113	126W	Adapter protector	6,6
	PIN	VOE14740817	126P	Locking device	1,4
	RETAINER	VOE14740818	126R	Retainer	

## Wheeled Excavators

### EWR130

Teeth/Adapters	Description	Part No.	Designation	Type/application	Weight kg
	ADAPTER	VOE 17491921	EA11TL25	Top Leg	4,8
		VOE 14744545	EA11TL30	Top Leg	4,2
	TOOTH	VOE 14744546	11GPE	General purpose	2,7
		VOE 14744547	11ARXE	Abrasive material with extra wear metal	3,2
	PIN	VOE 17473100	11P	Locking device	0,2
	RETAINER	VOE 17493100	11R	Retainer	
Teeth/Adapters	Description	Part No.	Designation	Type/application	Weight kg
	ADAPTER	VOE 14727403	EA16TL30	Top Leg	6,8
	TOOTH	VOE 14732376	16GPE	General purpose	4,1
		VOE 14732377	16ARXE	Abrasive material with extra wear metal	4,7
		VOE 14732378	16PPE	Extremely compact material	3,6
		VOE 14732379	16TPE	Extremely compact material	4
		VOE 14732380	16SNE	Levelling, cleaning, grading and backfilling	4,9
	PIN	VOE 17473101	16P	Locking device	0,2
	RETAINER	VOE 17493101	16R	Retainer	

### EWR150

Teeth/Adapters	Description	Part No.	Designation	Type/application	Weight kg
	ADAPTER	VOE 14727403	EA16TL30	Top Leg	6,8
	TOOTH	VOE 14732376	16GPE	General purpose	4,1
		VOE 14732377	16ARXE	Abrasive material with extra wear metal	4,7
		VOE 14732378	16PPE	Extremely compact material	3,6
		VOE 14732379	16TPE	Extremely compact material	4
		VOE 14732380	16SNE	Levelling, cleaning, grading and backfilling	4,9
	PIN	VOE 17473101	16P	Locking device	0,2
	RETAINER	VOE 17493101	16R	Retainer	



## EW160

Teeth/Adapters	Description	Part No.	Designation	Type/application	Weight kg
	ADAPTER	VOE 14727403	EA16TL30	Top Leg	6,8
	TOOTH	VOE 14732376	16GPE	General purpose	4,1
		VOE 14732377	16ARXE	Abrasive material with extra wear metal	4,7
		VOE 14732378	16PPE	Extremely compact material	3,6
		VOE 14732379	16TPE	Extremely compact material	4
		VOE 14732380	16SNE	Levelling, cleaning, grading and backfilling	4,9
	PIN	VOE 17473101	16P	Locking device	0,2
	RETAINER	VOE 17493101	16R	Retainer	
Teeth/Adapters	Description	Part No.	Designation	Type/application	Weight kg
	ADAPTER	VOE 14727405	EA21TL40	Top Leg	10
	TOOTH	VOE 14732381	21GPE	General purpose	6
		VOE 14732382	21ARXE	Abrasive material with extra wear metal	6,9
		VOE 14732383	21PPE	Extremely compact material	4,9
		VOE 14732384	21TPE	Extremely compact material	6,2
		VOE 14732385	21SNE	Levelling, cleaning, grading and backfilling	8
	PIN	VOE 17473102	21P	Locking device	0,2
	RETAINER	VOE 17493102	21R	Retainer	
	TOOL	VOE 17473120	11/126T	Tool	3

## EWR170

Teeth/Adapters	Description	Part No.	Designation	Type/application	Weight kg
	ADAPTER	VOE 14727403	EA16TL30	Top Leg	6,8
	TOOTH	VOE 14732376	16GPE	General purpose	4,1
		VOE 14732377	16ARXE	Abrasive material with extra wear metal	4,7
		VOE 14732378	16PPE	Extremely compact material	3,6
		VOE 14732379	16TPE	Extremely compact material	4
		VOE 14732380	16SNE	Levelling, cleaning, grading and backfilling	4,9
	PIN	VOE 17473101	16P	Locking device	0,2
	RETAINER	VOE 17493101	16R	Retainer	
Teeth/Adapters	Description	Part No.	Designation	Type/application	Weight kg
	ADAPTER	VOE 14727405	EA21TL40	Top Leg	10
	TOOTH	VOE 14732381	21GPE	General purpose	6
		VOE 14732382	21ARXE	Abrasive material with extra wear metal	6,9
		VOE 14732383	21PPE	Extremely compact material	4,9
		VOE 14732384	21TPE	Extremely compact material	6,2
		VOE 14732385	21SNE	Levelling, cleaning, grading and backfilling	8
	PIN	VOE 17473102	21P	Locking device	0,2
	RETAINER	VOE 17493102	21R	Retainer	
	TOOL	VOE 17473120	11/126T	Tool	3

**EW180**

Teeth/Adapters	Description	Part No.	Designation	Type/application	Weight kg
	ADAPTER	VOE 14727403	EA16TL30	Top Leg	6,8
	TOOTH	VOE 14732376	16GPE	General purpose	4,1
		VOE 14732377	16ARXE	Abrasive material with extra wear metal	4,7
		VOE 14732378	16PPE	Extremely compact material	3,6
		VOE 14732379	16TPE	Extremely compact material	4
		VOE 14732380	16SNE	Levelling, cleaning, grading and backfilling	4,9
	PIN	VOE 17473101	16P	Locking device	0,2
	RETAINER	VOE 17493101	16R	Retainer	
Teeth/Adapters	Description	Part No.	Designation	Type/application	Weight kg
	ADAPTER	VOE 14727405	EA21TL40	Top Leg	10
	TOOTH	VOE 14732381	21GPE	General purpose	6
		VOE 14732382	21ARXE	Abrasive material with extra wear metal	6,9
		VOE 14732383	21PPE	Extremely compact material	4,9
		VOE 14732384	21TPE	Extremely compact material	6,2
		VOE 14732385	21SNE	Levelling, cleaning, grading and backfilling	8
	PIN	VOE 17473102	21P	Locking device	0,2
	RETAINER	VOE 17493102	21R	Retainer	
	TOOL	VOE 17473120	11/126T	Tool	3

**EW220**

Teeth/Adapters	Description	Part No.	Designation	Type/application	Weight kg
	ADAPTER	VOE 14727405	EA21TL40	Top Leg	10
	TOOTH	VOE 14732381	21GPE	General purpose	6
		VOE 14732382	21ARXE	Abrasive material with extra wear metal	6,9
		VOE 14732383	21PPE	Extremely compact material	4,9
		VOE 14732384	21TPE	Extremely compact material	6,2
		VOE 14732385	21SNE	Levelling, cleaning, grading and backfilling	8
	PIN	VOE 17473102	21P	Locking device	0,2
	RETAINER	VOE 17493102	21R	Retainer	
	TOOL	VOE 17473120	11/126T	Tool	3
Teeth/Adapters	Description	Part No.	Designation	Type/application	Weight kg
	ADAPTER	VOE 14727406	EA31TL40	Top Leg	12,7
	TOOTH	VOE 14732386	31GPE	General purpose	7,8
		VOE 14732387	31ARXE	Abrasive material with extra wear metal	8,9
	PIN	VOE 17473103	31P	Locking device	0,3
	RETAINER	VOE 17493103	31R	Retainer	

## Attachment Selector Application

The Attachment Selector tool is a free global mobile Sales Tool for iOS and Android smartphones allowing to rapidly choose the right attachments for Volvo CE machines. This is a global tool, in which users can easily choose any of the 10 available languages. Taking the user through a straightforward selection process, the search results provide key sales information for users such as technical specifications or sales references. Truly a mobile app, wherever users are - online in the office or offline on site - they will be able to search for any attachment for a specific Volvo CE machine, or look for the right machine to match a specific reference.



Use the QR codes aside to get the free ATTACHMENT SELECTOR tool for IOS on App Store, for Android on Play Store and for China Android users.



Google Play Store QR code



Apple App Store QR code

